

CENTURY CITY OFFICE SPACE

NOW LEASING

Watt Plaza

1925 Century Park East, Suite 1990, Los Angeles, CA 90067

www.centurycityrental.com

Contact Michael at (310) 788-9089 or

michael@simkinlaw.com

Available office highlighted in the floorplan

Office 4: 10x15 (150 s.f.)

(all s.f. are approximate)

- ◆ Located on the 19th floor of prestigious Watt Plaza
- ◆ Brand new “built to suit” suite.
- ◆ LED lighting, open spacious modern layout
- ◆ Unobstructed sweeping views of Downtown and Hollywood Hills from every office and conference room.
- ◆ Modern reception area elegantly appointed with porcelain tile floor, artwork, new furniture.
- ◆ Large conference room with 16’ table, Herman Miller Aeron Chairs
- ◆ Space for support staff.
- ◆ Color copier and scanner.
- ◆ Fantastic Suite Mates!

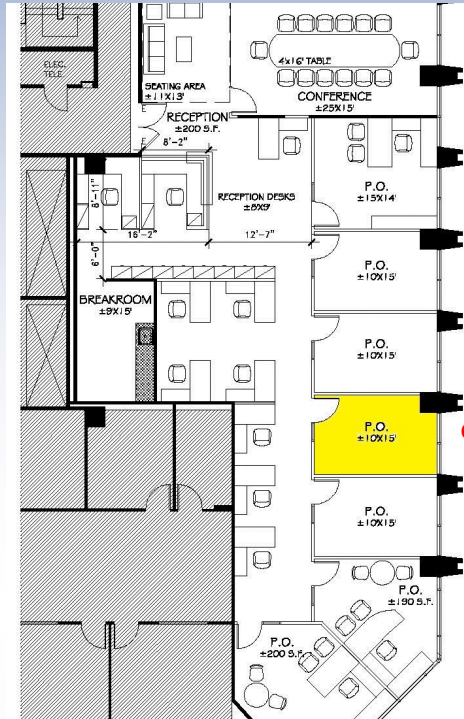

About Watt Plaza:

Class A twin 23-story office tower complex in the heart of Century City.

Building amenities include:

- ◆ Federal Express
- ◆ Chase Bank and 1st Century Bank
- ◆ Messenger Service/Copy & Print Center
- ◆ Notary service
- ◆ Car wash and auto service
- ◆ Electric charging stations
- ◆ GEM roundtrip car transportation to Westfield Shopping Center
- ◆ Starbucks, convenience store, two restaurants.
- ◆ Drycleaners

(Reception Area)



(City and Ocean views from Offices 1 & 4)



(Watt Plaza)

